



13 Treefern Close ABERGLASSLYN NSW

4 2 1

Nestled in a family-friendly pocket of Aberglasslyn, 13 Treefern Close presents the perfect opportunity to secure a well-appointed home offering comfort, enormous space, and convenience.

This inviting residence features four generous bedrooms, all designed with family living in mind. The master bedroom is complete with its own private ensuite, while the remaining bedrooms are serviced by a well-maintained central bathroom.

You'll find a functional and light-filled kitchen that flows seamlessly into the open-plan living and dining areas perfect for everyday living and entertaining alike. The layout offers a great balance of space and practicality,

[For full version visit the website](#)

Type : House
Price : Property Preview
Land Size : 114.5 sqm
View : <https://www.petersrealestate.com.au/sale/nsw/hunter-valley-lower/aberglasslyn/residential/house/8677406>



Lachlan Doyle
02 4933 7855

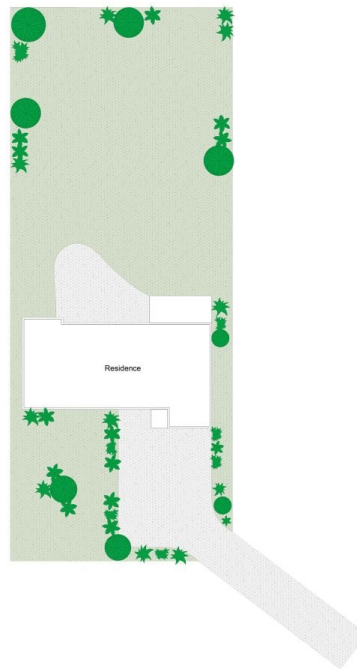

13 Treefern Close
Aberglasslyn

-  4 Bed
-  2 Bath
-  2 Car



Illustration for
identification
purposes only,
measurements are
approximate only
and not to scale